

# Intermountain Physician Portal (intermountain.net) Access Steps

If you haven't already set up the PingID 2-Factor Verification app on your smartphone, please go to the Affiliated Support Site [ihchelp.info](http://ihchelp.info) -> **2-Factor Auth / DSA Portal / Physician Portal Resources** -> **Option 1** and step through the Setup Guide. Once PingID is in place, you will be able to access the Physician Portal.

1. Go to URL: <http://intermountainphysician.org> (where you should see a page similar to the one below) and click **Log in to access secure content** in the upper left corner:

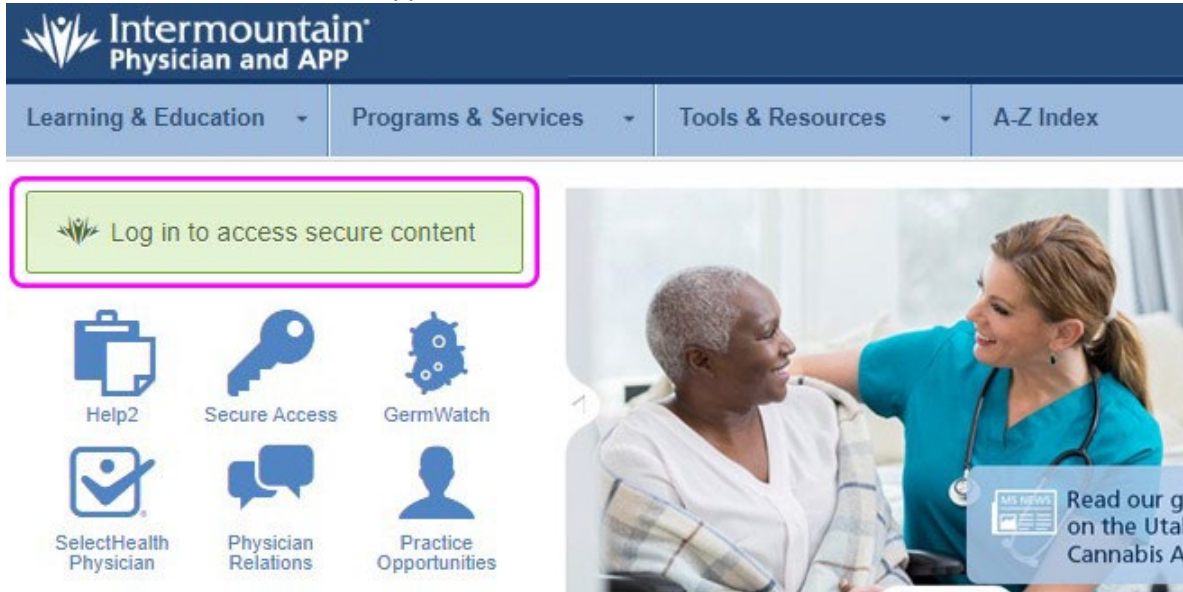

2. In the window that appears, enter your Intermountain userid or imail2.org address (if known/available) and, if this is a personal device and if preferred, check the *Remember my username* box then click *Next*. Click *PingID*, then *Sign On*, and authenticate in PingID to complete login:

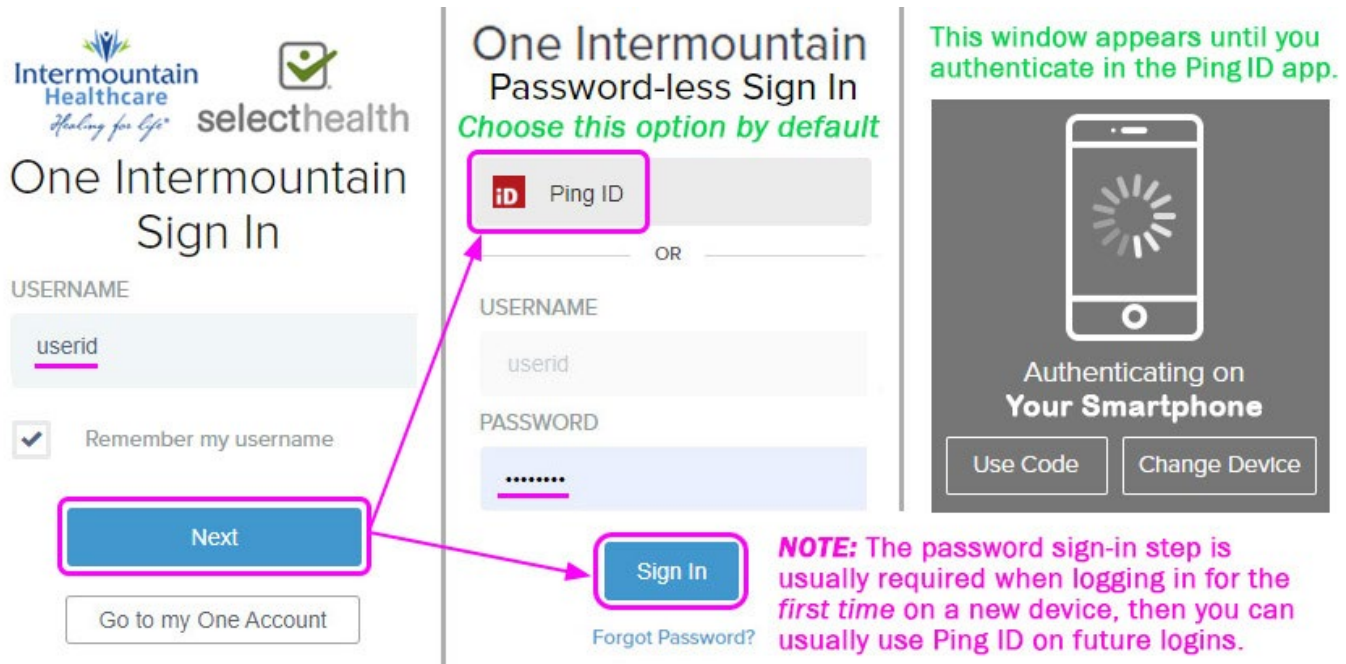

# Accessing Clinical Resources (eResources) on the Intermountain Physician Portal

Once logged into the Physician Portal, here is how to access the various Clinical Resources, typically referred to as *eResources* in HELP2 & iCentra/PowerChart:

The screenshot displays the Intermountain Physician Portal's Clinical Library page. The browser address bar shows the URL <https://phy.intermountain.net/Pages/home.aspx>. The top navigation bar includes 'Intermountain Physician and APP', 'Learning & Education', 'Programs & Services', 'Tools & Resources', and 'A-Z Index'. The 'Tools & Resources' menu is expanded, showing 'Clinical References' highlighted. The main content area is titled 'Clinical Library' and features a search box labeled '3c'. Below the search box is the contact information for a medical librarian: 'AskALibrarian@imail.org' and 'Email a Medical Librarian for help with your information needs.' The page is organized into three columns: 'Clinical Resources' (3a) listing various databases like Lexicomp, PubMed, and EBSCO; 'Popular Resources' (3b) listing journals like JAMA and NEJM; and 'Resources for Clinical Programs' listing specialties like Behavioral Health, Cardiology, and Oncology. A 'More Clinical Resources>>' link is located at the bottom of the 'Clinical Resources' column.

1. Click *Tools & Resources* in the top middle menu bar
2. Click *Clinical Resources*, which will open the Clinical Library page
- 3a. The *Clinical Resources* typically found in the iCentra eResources page are listed in the lower left column
- 3b. *More Clinical Resources* are accessed using the link at the bottom of the lower left column
- 3c. You can also use the *Search* box below the page title to search for a specific resource